



Work with our students



Facility

PLACEMENT AND GRADUATION ASSIGNMENTS

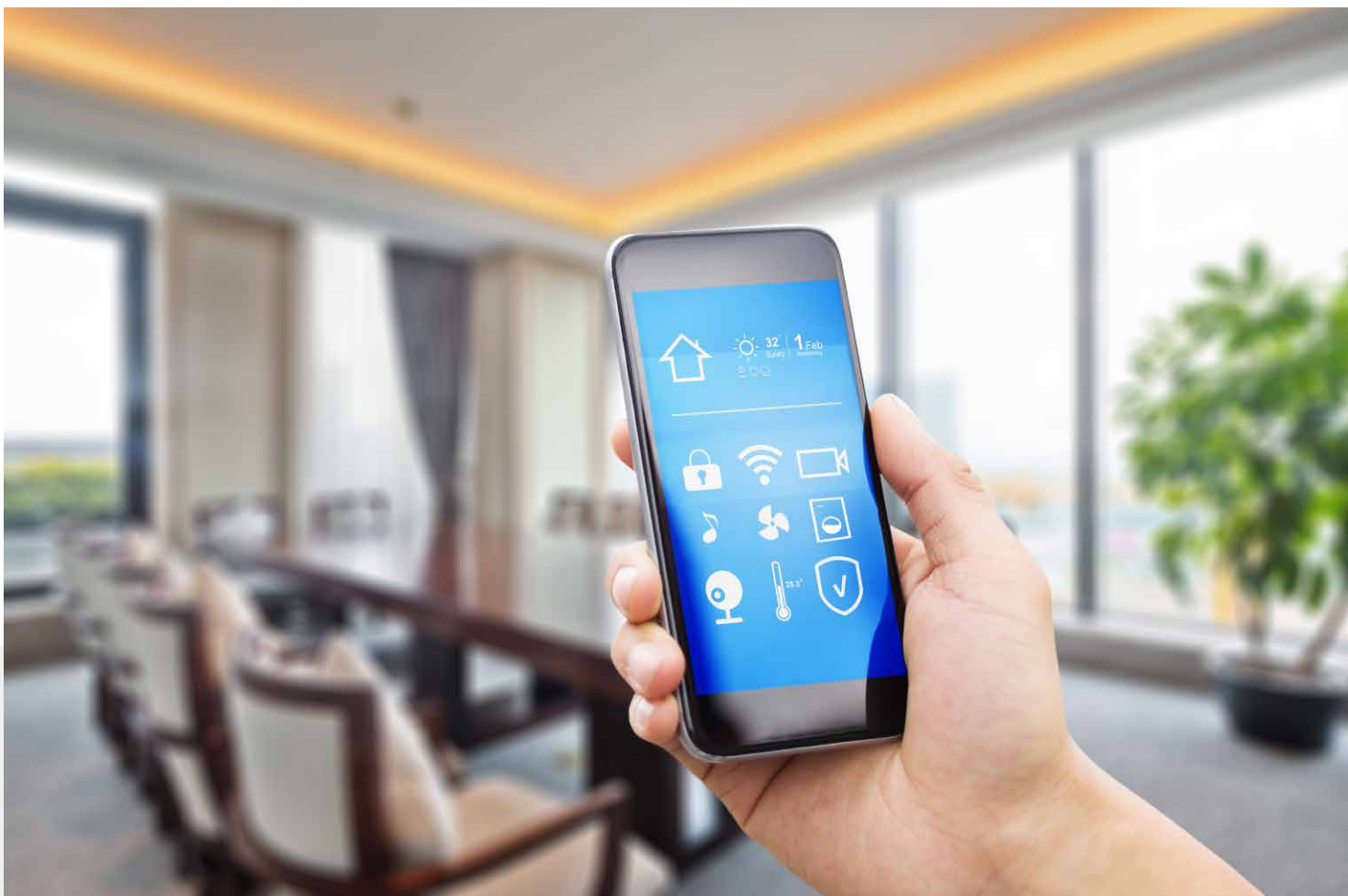

DISCOVER YOUR WORLD

BUas.nl

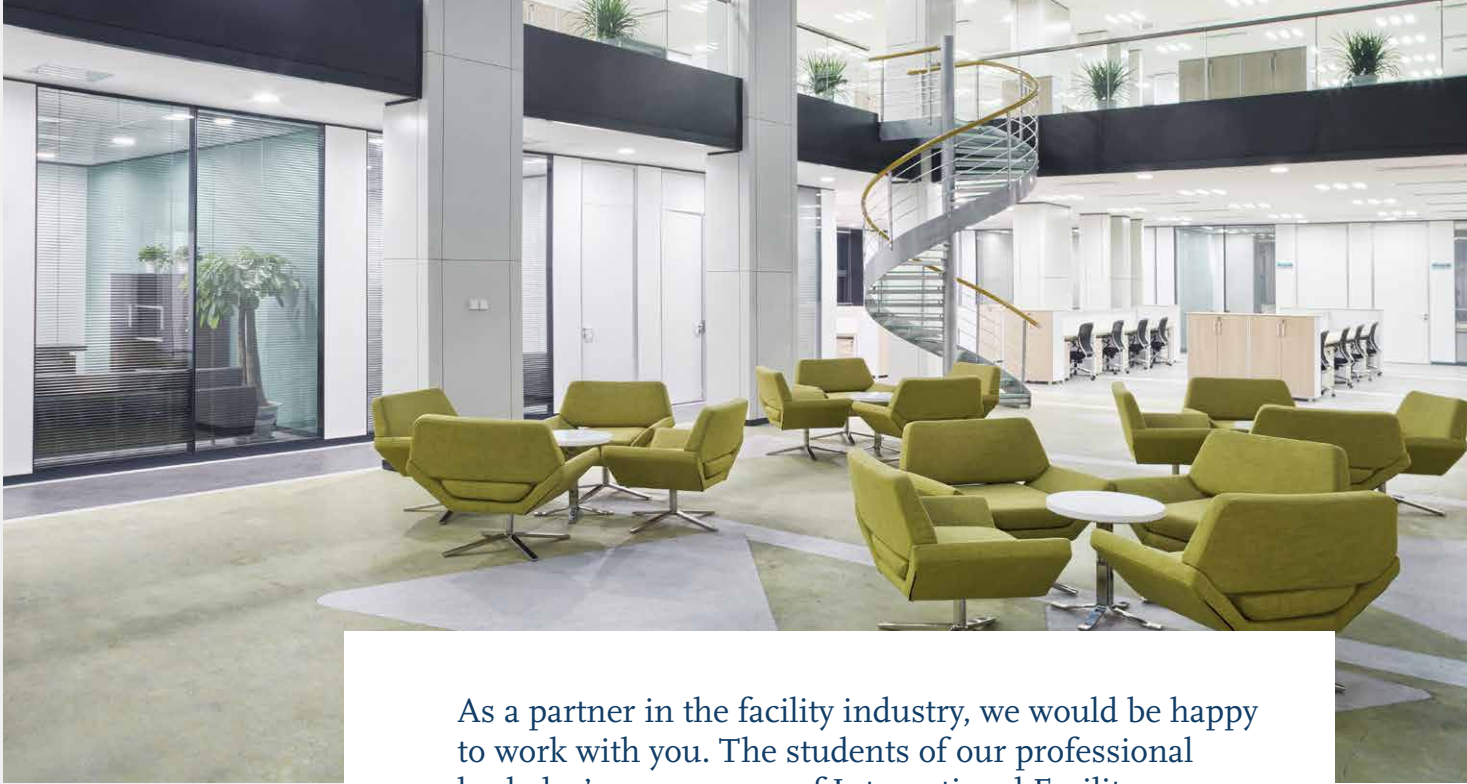

As a partner in the facility industry, we would be happy to work with you. The students of our professional bachelor's programme of International Facility Management can set to work for you on a placement or graduation assignment.

International Facility Management

The professional bachelor's programme of International Facility Management is taught in English and prepares students for careers in the international facility management industry. The programme has a practical orientation and is delivered by highly qualified and international lecturers with years of experience in the industry. Our students learn how to effectively manage facility processes and how facility managers can contribute to decision-making at strategic level.

In their first year of study, students attend practical courses in our kitchen, restaurant and catering facilities, with specific attention for company emergency response procedures and safety issues. In year two, they acquire management experience by overseeing first-year students. Apart from practical and theory courses, students focus on developing professional, personal and intercultural skills as well as carrying out applied research.

The main phase of the degree programme is structured around the following themes:

- > Developing People and Organisations
- > Managing Business Performance and Innovation
- > Creating Excellence in Facility Management

Students perform a 24-week work placement in year two or three and they complete their degree by means of a graduate research project in their final year of study.

PROGRAMME FACTS

- > English-taught
- > 4 years, 3-year track available to pre-university graduates
- > 24-week work placement in year 2 or 3
- > Graduate research project of 6 to 9 months
- > Degree title: Bachelor of Science
- > Career examples: facility manager, innovation manager, work environment advisor, event manager
- > Possible employers: multinational companies, hotels, hospitals, airports, catering businesses, event organisers

We are Breda University
of Applied Sciences

Some 7,000 students from over 100 countries are studying at our international higher education institute. Our campus is situated in the south of the Netherlands, in the city of Breda, only 100 km from both Amsterdam and Brussels. Our institute, formerly known as NHTV Breda, was founded in 1966 as a provider of bachelor's courses in tourism and leisure, and in this field it is currently the largest and leading education institute in the world. New professional and academic bachelor's and master's programmes have been developed since then. Today we offer degree programmes in the domains of Games, Media, Hotel, Facility, Logistics, Built Environment, Tourism and Leisure & Events.

Courses taught in the programme	YEAR 1		YEAR 2		YEAR 3		YEAR 4	
	Semester 1	Semester 2	Semester 3	Semester 4	Semester 5	Semester 6	Semester 7	Semester 8
Subjects								
Operations Management	•			•				
Management Information Systems (MIS)	•			•				
Management Development Programme (MDP)	•	•	•	•		•		
Finance		•						
Economics		•	•					
Marketing		•		•				
Business Law & Ethics		•	•					
Investigative Abilities		•	•			•		
English		•	•			•		
Organisational Behaviour			•					
Accounting				•				
Placement					•			
Sustainable Strategic Business Design						•		
Graduation Phase							•	•



Good to know

- > Our International Facility Management programme has received official accreditation from the Accreditation Organisation of the Netherlands and Flanders (NVAO).
- > Furthermore, the NVAO has awarded our study programme a label of excellence for 'Industry Collaboration' and a distinction for 'Internationalisation'.
- > The programme has also been awarded a label of excellence by the Dutch government for close cooperation with the Facility Management industry.
- > International recognition by the International Facility Management Association (IFMA) underlines the quality of our education.
- > The programme is the first and only one in the Netherlands with a Certificate of Quality in Internationalisation from the European Consortium of Accreditation (ECA).



You have to be a real go-getter!



After completing my degree, I started working with an **UMBRELLA ORGANISATION OF 240 DAY NURSERIES**. My job involves the complete spectrum of facility management aspects. I am responsible for several services, such as cleaning, budget management, and maintenance of the nurseries. What's more, I keep a close watch on trends and developments in the market, in order to improve our services. This programme taught me nearly all aspects of the profession. After all, facility services are needed in all levels of an organisation. You have to be a real go-getter, and the school offers you a great deal of choice in your studies. For instance, in my third year, I organised the field trip for students, together with a number of fellow students."

Suzanne Steehouder

Graduated in International Facility Management
Currently employed by an umbrella organisation of day nurseries

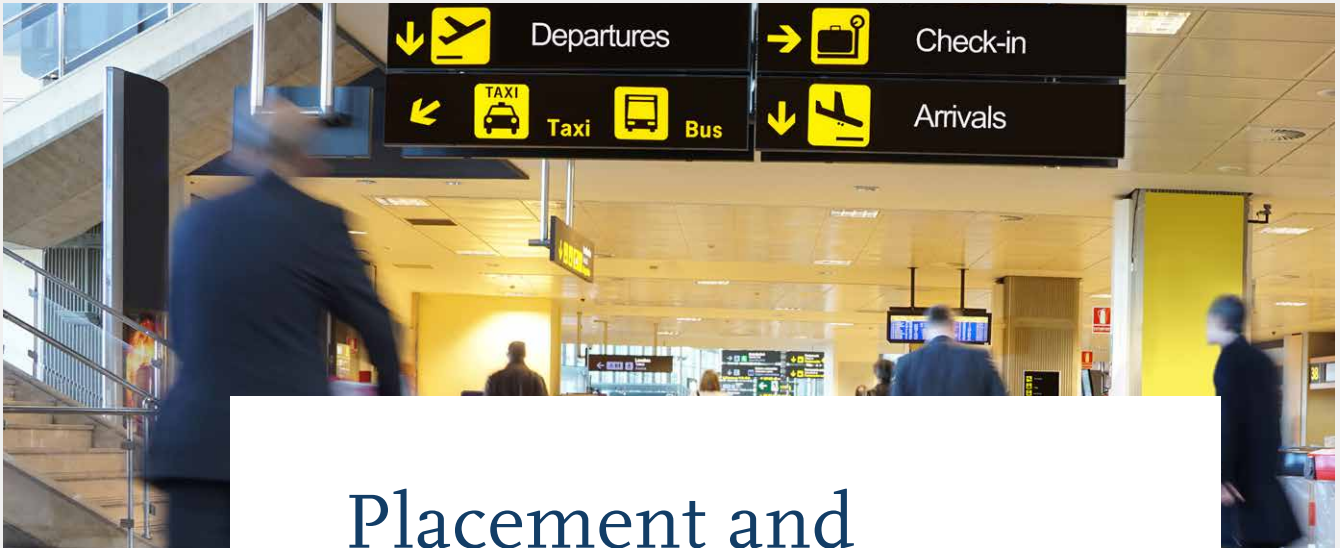

Placement and graduation assignment

Do you have an interesting placement position or graduation assignment? Why not consider engaging our students!

Our students are keen on acquiring practical experience, preferably abroad. The aim is for the student to fully assist in the day-to-day operations of your organisation. In addition, the student will also work on one or more specific assignments during the placement period and will submit a report containing conclusions and recommendations. If you engage a student during the graduation phase, it will be possible for this student to carry out a larger-scale research project.

Student availability

Our students are available for a (full-time) work placement of 24 weeks in their second or third year of study. There are two periods during which you can host a student for a placement: from mid-February to July/August (year two) or from July/August to mid-February (year three). In their last year of study, our students are available for a graduate research project lasting six to nine months.

Why work with our students?

Our students completing a work placement in your organisation can be expected to:

- > be interested in and familiar with your line of business
- > be able to analyse a problem or issue
- > have detailed and topical knowledge relevant to carrying out the assignment(s)
- > be able to write an advisory report on implementation process(es)
- > be able to work on projects individually and in teams
- > operate effectively in an international working environment
- > be able to work in a flexible, creative, independent, communicative and solution-oriented manner





How can our students help you?

As a part of the learning experience during the work placement, students complete a number of reports and assignments during the 24-week placement period. One of these is a Company Assignment, the subject of which is agreed between the student and the placement host company, and it is designed to add value to the organisation. A few examples of project-based assignments can be found below.

Internal Client

- > Implementing a Facility Management Information System (FMIS)
- > Composing a procedure handbook of the facility services organisation
- > Formulating Service Level Agreements (SLAs)

Purchase and Supplier Management

- > Setting up a programme of requirements for the acquisition of a product or service
- > Formulating a purchasing E-policy
- > Conducting research on possible improvements regarding, for instance, the procurement of goods

Cleaning

- > Constructing and/or reconstructing work rosters in such a way that they can be used efficiently and effectively by all parties involved
- > Making an inventory of the spaces in one or more buildings in order to achieve a realistic work frequency and price indication
- > Offering support in the implementation of the quality system of a cleaning company

Workplace Accommodation and Maintenance

- > Preparing a programme of requirements for activities related to Accommodation and Maintenance
- > Benchmarking the facility management organisation as a whole or a certain component of it
- > Developing a plan for relocation

Housekeeping

- > Conducting research into the efficiency within the housekeeping department
- > Carrying out research into the issue of industrial clothing (name, size, cost-benefit, etc.)
- > Conducting research into procedures regarding the provision of industrial clothing

Logistics

- > Improving the stock records in various buildings of the organisation
- > Drawing up an inventory list and pricing policy
- > Formulating guidelines in order to achieve the best possible in-stock inventory

A few examples of graduation assignments

- > Most effective management style for a modern workplace
- > Human behaviour part of workplace re-design and the usability
- > Creating sustainable facilities within the organisations' customer journey
- > Workplace Management, Innovation and Process design
- > The added value of information management to corporate real estate management
- > Client participation within facility related processes in the mental healthcare

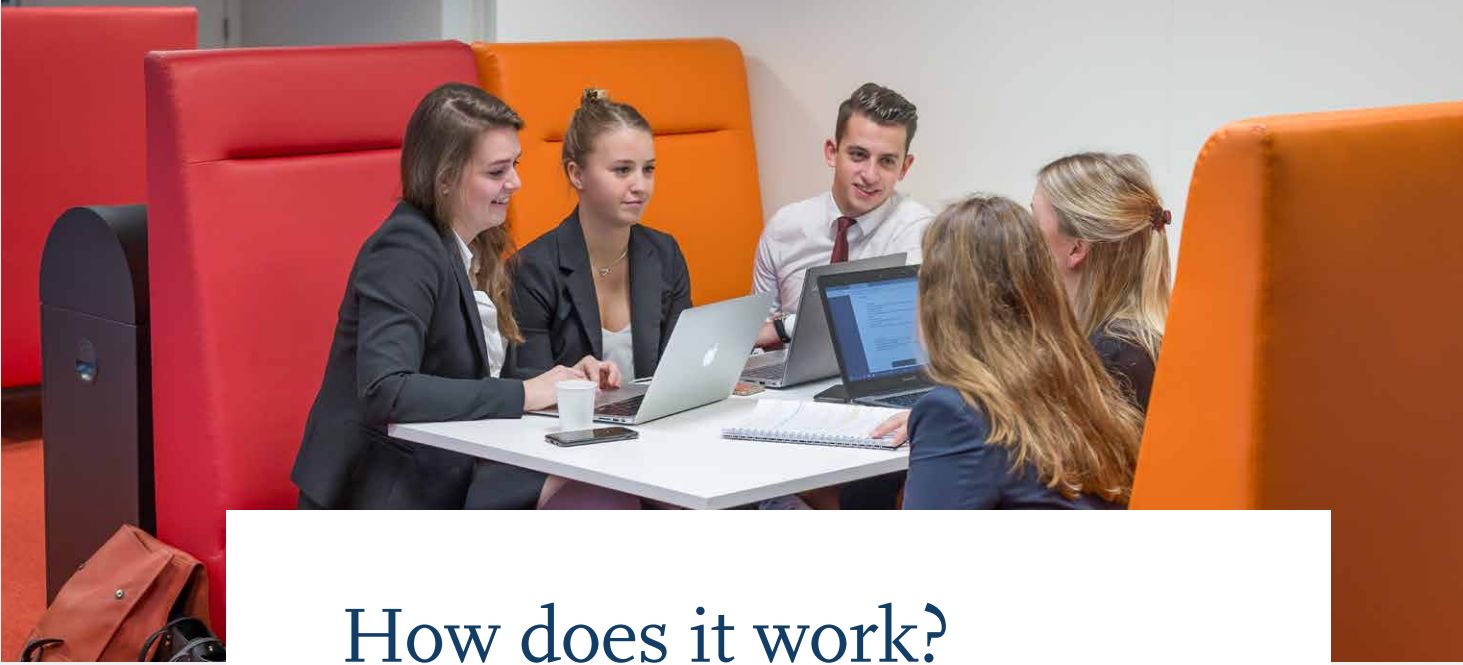

How does it work?

The practical details regarding work placements

The work placement

The work placement is an important component of the study programme, aimed at giving students the opportunity to apply their acquired knowledge and skills to real-life, professional situations in order to learn from this process. During the placement period, students will be required to develop several competencies (or develop them further) as defined by the degree programme staff.

On the part of the degree programme, the student will be supervised by a lecturer. The role of this supervising lecturer comprises, among other things, evaluating the work placement by means of talks with the student and the company supervisor. This is done twice during the placement period: once halfway through the placement (interim) and once at the end (final). The final evaluation will be carried out by the company supervisor and the supervising lecturer via telephone or Skype.

If you are interested in working with our students, please be aware of the following requirements for host companies:

- > During the work placement, the student will participate for a period of 24 weeks in a department within your organisation.
- > For about 90% of the time and during working hours, the student will work on a company assignment defined by you (together with the student).
- > You will appoint a company supervisor for the purpose of introducing the student to your employees, supervising the student's performance and assignments, and having regular progress talks with the student (at least twice). These supervision activities will cost you about 90 minutes per week.
- > Your company will be ultimately responsible for the work carried out by the student.
- > The host company offers a professional workplace and preferably a reimbursement for costs incurred (travel expenses, accommodation). Whenever possible, students arrange their own insurance and, if necessary, a work permit and visa. Arrangements in terms of access, company clothing, meals, any confidentiality of information, and so on will be laid down in a contract.



SELF SERVICE

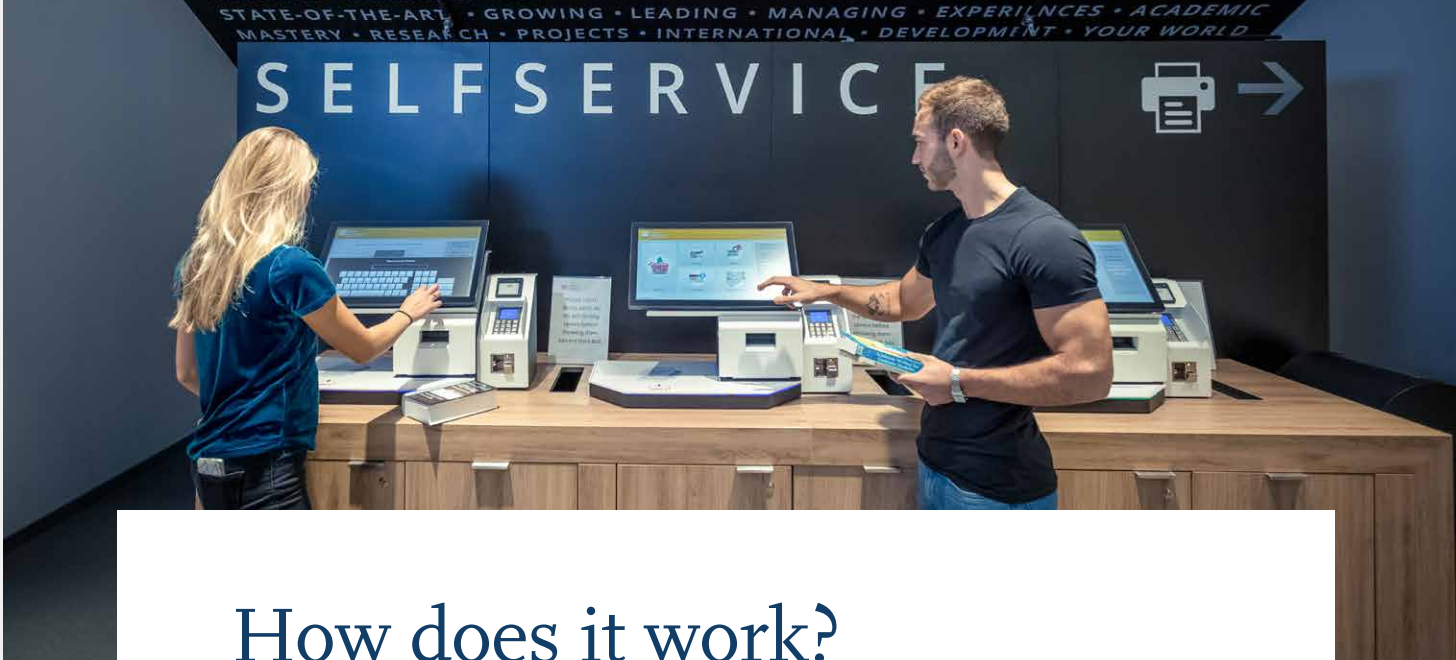

How does it work?

The practical details regarding graduate projects

The graduate research projects

Upon completion of the theoretical part of the programme and the work placement, the student will put his or her knowledge to use in a graduate research project.

On the part of the degree programme, the student will be supervised by a lecturer. The role of this supervising lecturer will include evaluating the student's research project.

If you are interested in working with our students, please be aware of the following requirements for host companies:

- > You may expect the student to be able to work independently. The time to be spent on guidance and support does not need to be more than 1 or 2 hours a week (after an induction period).
- > Alongside his or her research assignment, a student may also assist in the workday activities of your company. However, the student's performance of the workday activities will not be subject to assessment.
- > You will appoint a company supervisor for the purpose of introducing the student to your employees, discussing the graduation proposal and assignment description(s) with the student, and supervising the student (focusing on the assignment).
- > The student will have access to the necessary information (annual report, policy plans, etc.).
- > Your company will be ultimately responsible for the work carried out by the graduate student.
- > The host company offers a professional workplace and preferably a reimbursement for costs incurred (travel expenses, accommodation). Whenever possible, students arrange their own insurance and, if necessary, a work permit and visa.

How to submit your vacancy

If you have a suitable and challenging placement or graduation assignment, please inform us by submitting your offer via: PlacementofficeFM@buas.nl.

Do you have any questions or would you like to discuss what would best suit your company or assignment? Please feel free to send an e-mail to our placement office and we will contact you as soon as possible.





We would be happy to work for you!

We and our students are always keen on gaining valuable practical experience in renowned organisations in the facility management industry. Do you have an interesting placement position or an intriguing research assignment for one or more of our students? We would be happy to work for you.

Mgr. Hopmansstraat 2
4817 JS Breda

P.O. Box 3917
4800 DX Breda
The Netherlands

PHONE
+31 76 533 22 03

E-MAIL
PlacementofficeFM@buas.nl

WEBSITE
www.buas.nl

EDITORS
Breda University of Applied Sciences
Marketing and Communication

GRAPHIC DESIGN
Waldo van Bokhoven | BOWfor
Arno van der Linden | BUas

PHOTOGRAPHY
Andy van Tilborg
Shutterstock

PRINT
Notten Grafische Oplossingen

June 2019 edition

No rights can be derived from
the information in this prospectus



DISCOVER YOUR WORLD



Breda
University
OF APPLIED SCIENCES

BUas.nl